

Easy-to-own homes. Easy life!



shiv
शिवशिकार
RESIDENCY

Plot no. 15, Sector- 19, Taloja, Navi Mumbai.

1 & 2 BHK PREMIUM RESIDENCES

IT IS TALOJA'S BEST KEPT

SECRET

EVER IMAGINED LIVING IN THE

HEAVEN,

IT IS HERE. IT IS HERE.

IT IS HERE.

A woman with dark hair, wearing a purple halter-neck dress with a large circular brooch at the waist and a pleated skirt, is sitting on a patterned sofa. She is looking thoughtfully to the right. The background is a wall with a dark, intricate floral wallpaper. The overall mood is elegant and sophisticated.

It's no wonder that life in the city is getting more and more chaotic. Where space is becoming the utmost luxury and luxury is trapped in the whirl of compromises. Thankfully, the privileged few like you can get more from life. More space, more comfort, more luxury, more to lifestyle and hence, even more peace. All at one address, that is cuddled with hills and lush greens at the heart of Taloja. Welcome to Shiv Shankar Residency. Where you will experience ecstatic bliss while living overwhelmingly high against the verdant hills in the atmosphere that is nothing less than heavenly. This stunning project is Taloja's best kept secret till now. Come; explore the secret of high living.



1 & 2 BHK Luxury Apartments

An edifice with a limitless expanse.
Offering limitless joy.

Soaring 13 storeys high, Shiv Shankar Residency stands true to your expectations. One more iconic project from the house of ABHISHEK ENTERPRISES, it is exceptional in design and magnificent in scale. For all you know, it has at your disposal every possible facet of a great lifestyle. So to speak, if you're looking for an unlimited life that gives you unlimited joy, you are at the right address.



Project highlights:

- Clear title CIDCO transfer plot
- G+13 Storey Residential cum Commercial project
- Shops , 1BHK & 2BHK with terrace flats
- Quality construction with earthquake resistance RCC structure
- Reputed brand Automatic Elevators
- Stilt Car Parking
- Power Backup for Elevators and Common Areas
- CCTV Camera



PODIUM VIEW



The Facilities

The outdoors offer limitless extravagances.
With limitless bliss.



It's not just homes when one says luxury; a variety of things come into the picture. A great ambience, state-of-the-art clubhouse, picturesque gardens, and the feel of living in paradise. At Dhana-Shree Pearl, by carefully considering every detail, we extend the idea of just living into limitless living.

- Children play area
- Hi-tech Gymnasium with modern equipments
- Beautiful Landscaped Garden
- Indoor sports are - Carrom Board, Table Tennis & Chess
- Yoga Room • Society Office
- Senior Citizen area



Taloja, Navi Mumbai

Surrounded by a limitless world.
With limitless connectivity.

Nothing is more exciting than a place that extends on all sides with life's purest joys. If you're well-connected with all of them, your happiness would know no bounds. A quite, nature-wise wealthy suburb of Navi Mumbai, Taloja has all that you expect from the place you reside.



Location features:

- Off old Mumbai-Pune Highway (NH4) and touching Kharghar node
- Upcoming Metro rail station in Taloja
- 5 mins. walking distance from Taloja Panchand railway station
- 15 mins. drive to Navi Mumbai international airport
- 10 mins. drive from Mumbai-Pune or Mumbai-Goa highway
- 5 mins. drive from Asia's largest Central Park and 18 hole golf course
- 5 mins. drive to ISKCON temple
- Well connected to the proposed Alibaug-Virar highway
- Planned by one of India's best planner – CIDCO
- Excellent education and medical facilities in close proximity
- Gardens, spacious playgrounds and schools in the vicinity



TO THANE



NH4

shiv
शिवशंकर
RESIDENCY



Specification



**A home that endows you limitless luxuries.
With limitless comfort.**



TILING

- Vitrified flooring in all rooms
- Anti skid tiles in attached terrace area
- Decorative checkered tile compound

KITCHEN

- Granite platform with stainless steel sink & service platform
- Dado tiling up to the beam level
- Provision of Modular kitchen

TOILETS

- Designer bathroom with branded sanitary ware
- Concealed plumbing with premium quality CP fittings
- Geyser connection in all bathrooms

DOORS & WINDOWS

- Paneled European-styled doors in every room with elegant handles & locks
- Anodized sliding windows with tinted glass
- Wooden / Plywood frames for all doors

WALLS & PAINTS

- Gypsum finished internal walls
- Plastic paints of premium quality on interior walls
- External texture finished with Roofit Mix

ELECTRIFICATION

- Provision for telephone, TV & internet connection in all rooms
- Branded concealed copper wiring with MCB / ELCB & Modular switches with adequate points





Ground Floor Plan





First Floor Plan





Typical Floor Plan
(2,4,6,8,10 & 12)





Typical Floor Plan
(3,5,7,9 & 11)





Thirteen Floor Plan



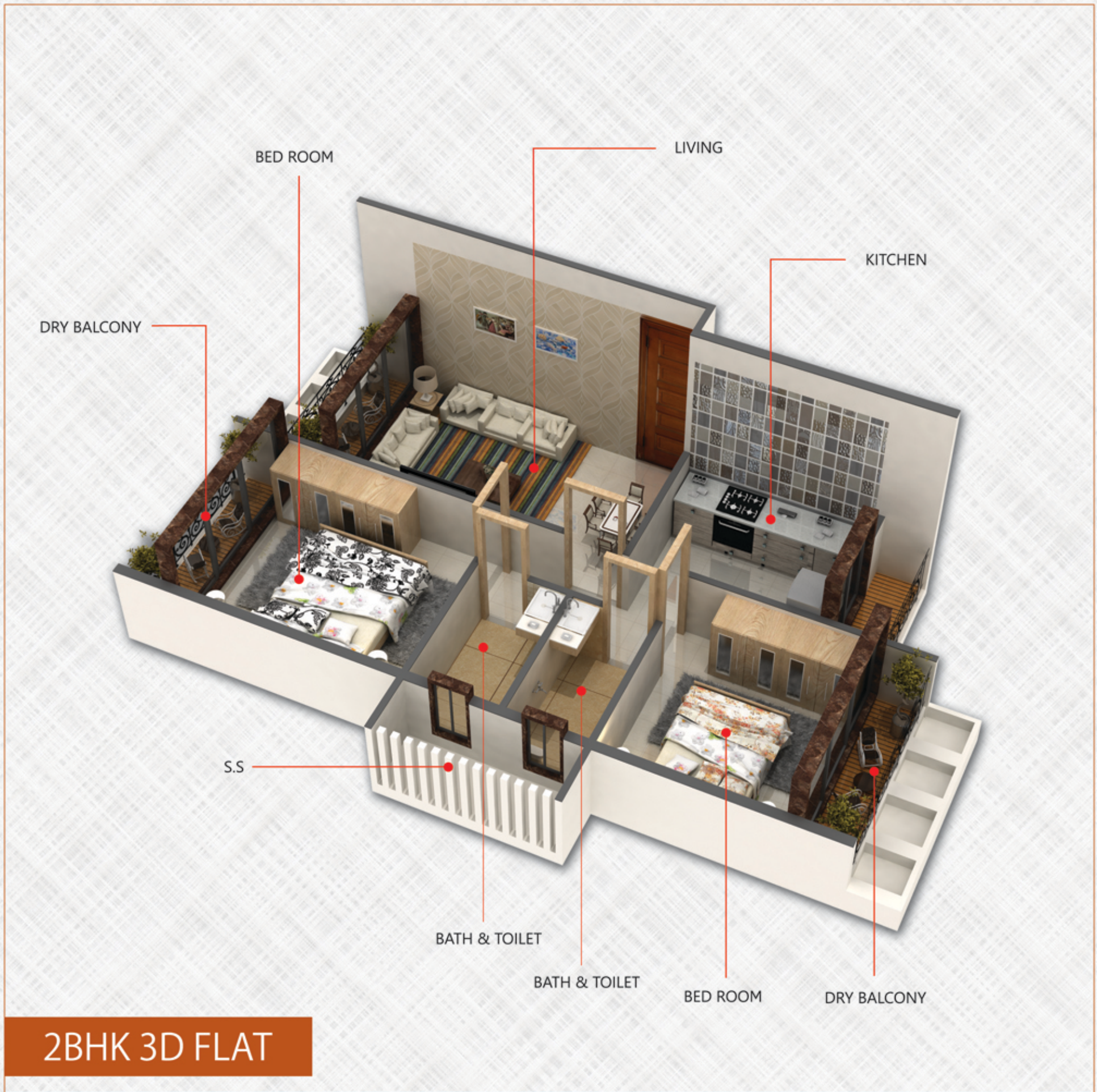

2BHK 3D FLAT

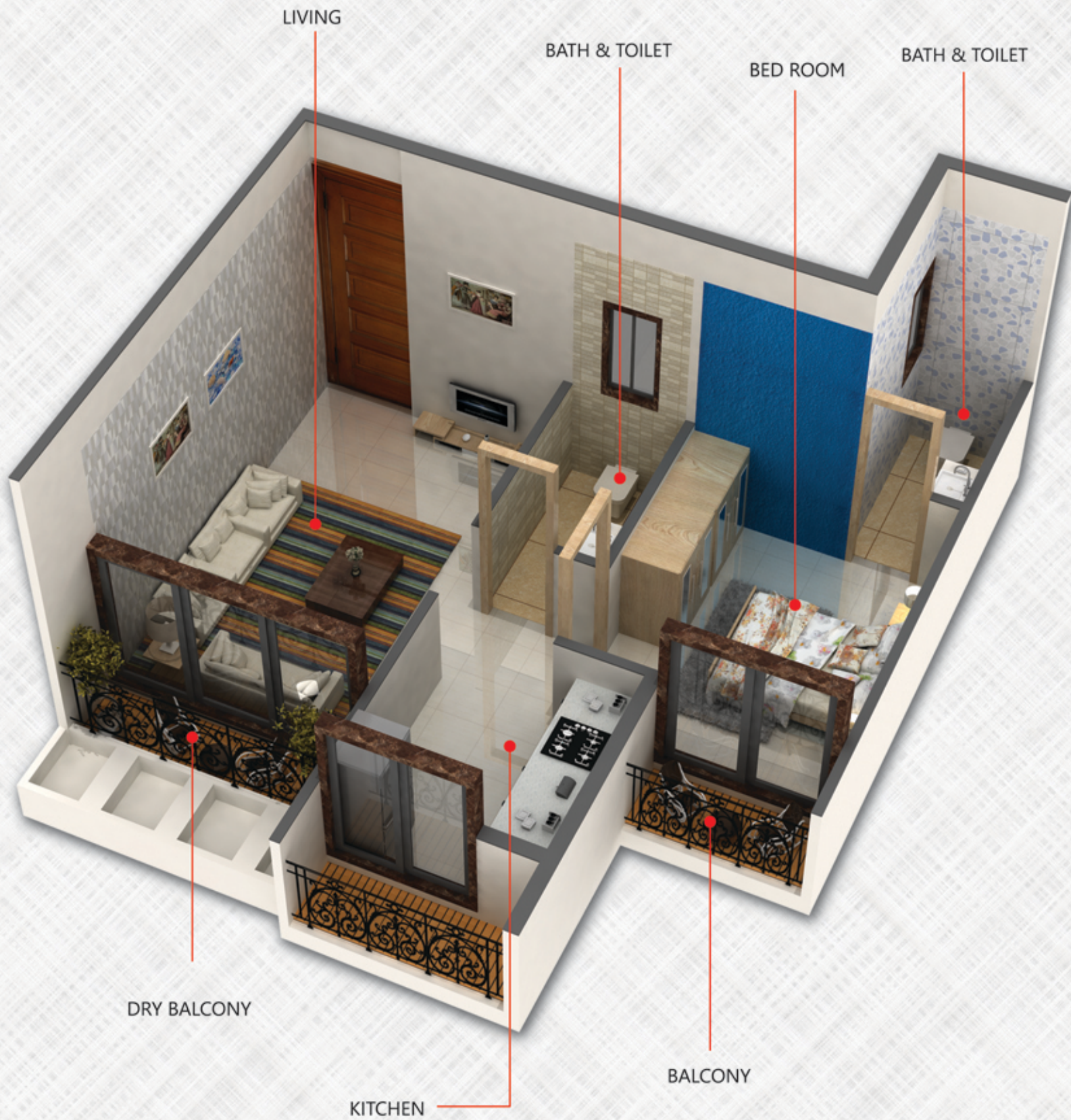

LIVING

BATH & TOILET

BED ROOM

BATH & TOILET

DRY BALCONY

KITCHEN

BALCONY

1BHK 3D FLAT

RCC Consultant :
B S SUKTHANKAR & ASSOCIATES

Architect :
ATUL PATEL

Legal Adviser :
B S SUKTHANKAR & ASSOCIATES



MAHARERA REGISTERED PROJECT

Project by

Abhishek Enterprises

BUILDERS & DEVELOPERS

OFFICE ADD :

Office No. 603, Plot No. 87, Shelton Cubix, Sector. 15, CBD Belapur, Navi Mumbai - 400 614

Email : abhishekenterprises.1976@gmail.com

Website : www.abhishekenterprises.us

For Booking Contact

8080241671 | 9819713902 | 022 27573061

This communication is purely conceptual and is not a legal offering. It is made for only promotional purposes. The information contained in this communication is only indicative of the kind of development that is proposed and is subject to change. The developers reserve the right to make change or alterations at their sole discretion.